

THE **DBS SERIES** HYDRAULIC BOLT TENSIONERS WILL ENSURE UNIFORMED GASKET COMPRESSION.

Compression is essential for the integrity of critical bolted flange connections. Unlike a torque wrench, the DBS Series Bolt Tensioners are capable of tightening more than one bolt at a time and can apply a consistent torque via direct axial stretching to any given number of bolts simultaneously. These tensioners have been designed to fit all standard ANSI & API flanges with quick release bridge incorporating hexagon socket for a fast change over. There are 9 load cells with a bolt size range from M20 to M115 or 3/4" to 4-1/2" 8UN and they are light and easily handled. All load cells are electroless nickel plated for extra protection and are easily maintained.



DBS-7

DBS-4

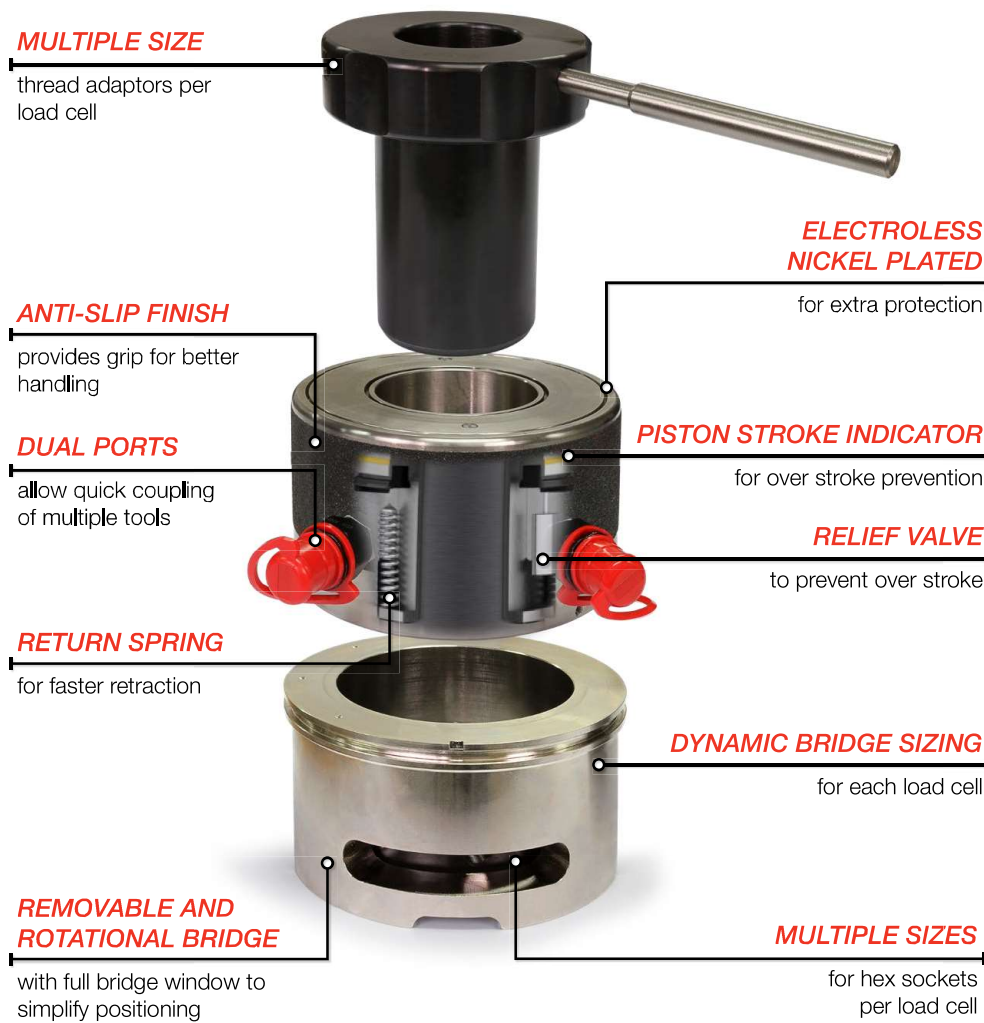

**CAPACITY**  
**160 - 4,100 kN**

**STROKE**  
**8 - 10 mm**

**BOLT RANGE**  
**3/4" - 4-1/2" or M20 - M115**

**MAXIMUM OPERATING PRESSURE**  
**1,500 bar**

**T**  
**BOLTING SOLUTIONS**

Model	DBS-0	DBS-1	DBS-2	DBS-3	DBS-4	DBS-5	DBS-6	DBS-7	DBS-8
<b>Metric Bolt Dimensions (Ø * pitch)</b>	M20x2.5	M24x3	M24x3	M33x3.5	M39x4	M52x5.5	M72x6	M90x6	M105x6
	M22x2.5	M27x3	M27x3	M36x4	M42x4.5	M56x5.5	M76x6	M95x6	M110x6
			M30x3.5	M39x4	M45x5	M60x5.5	M80x6	M100x6	M115x6
			M33x3.5	M42x4.5	M48x5	M64x6	M85x6		
			M36x4			M68x6	M90x6		
<b>Imperial Threads (Ø in-)</b>	3/4" 10UN	1" 8UN	1" 8UN	1 1/4" 8UN	1 1/2" 8UN	2" 8UN	2 3/4" 8UN	3 1/2" 8UN	4" 8UN
	7/8" 9UN	1 1/8" 8UN	1 1/8" 8UN	1 3/8" 8UN	1 5/8" 8UN	2 1/4" 8UN	3" 8UN	3 3/4" 8UN	4-1/4" 8UN
			1 1/4" 8UN	1 1/2" 8UN	1 3/4" 8UN	2 1/2" 8UN	3 1/4" 8UN	4" 8UN	4-1/2" 8UN
			1 3/8" 8UN	1 5/8" 8UN	1 7/8" 8UN	2 3/4" 8UN	3 1/2" 8UN		
					2" 8UN				
<b>Maximum Pressure (bar)</b>	1,500	1,500	1,500	1,500	1,500	1,500	1,500	1,500	1,500
<b>Effective Area (mm<sup>2</sup>)</b>	1,067	1,867	3,003	4,400	6,669	10,002	16,670	21,336	27,336
<b>Maximum Force (kN)</b>	160	280	450	660	1,000	1,500	2,500	3,200	4,100
<b>Maximum Piston Stroke (mm)</b>	8	10	10	10	10	10	10	10	10
<b>Retraction Type</b>	Manual	Spring	Spring	Spring	Spring	Spring	Spring	Spring	Spring
<b>Load Cell Weight (kg)</b>	1.5	2.1	3.3	4.1	7.2	9.3	14.4	19.2	28.0
<b>Approx. Thread Adaptor Kit (kg)</b>	1.0	1.6	2.2	3.4	4.3	9.2	18.6	27.8	35.5
<b>Approx. Total Weight (kg)</b>	2.5	3.7	5.5	7.5	11.5	18.5	33.0	47.0	63.5

## HYDRAULIC BOLT TENSIONERS

T

BOLTING SOLUTIONS

Model	Max. Pressure (bar)	Max. Load Capacity (kN)	Max. Stroke (mm)	Effective Area (mm <sup>2</sup> )	Thread Specification	Nut Size	A (mm)	B (mm)	C (mm)	D (mm)	G°	H (mm)	L (mm)
DBS-0	1,500	160	8	1,067	M20x2.5	30	63.0	45.0	36.0	113.5	70.0	19.0	-
					M22x2.5	32	63.0	45.0	36.0	113.5	70.0	21.0	-
					3/4" 10UN	1-1/4"	63.0	45.0	36.0	113.5	70.0	22.0	-
					7/8" 9UN	1-7/16"	63.0	45.0	36.0	113.5	70.0	25.0	-
DBS-1	1,500	280	10	1,867	M24x3	36	68.0	50.5	38.0	141.5	70.0	23.0	-
					M27x3	41	68.0	50.5	38.0	141.5	70.0	26.0	-
					1" 8UN	1-5/8"	68.0	50.5	38.0	141.5	70.0	30.0	-
					1-1/8" 8UN	1-13/16"	76.0	50.5	41.0	144.5	70.0	33.0	-
DBS-2	1,500	450	10	3,003	M24x3	36	75.0	50.5	38.0	141.5	60.0	23.0	-
					M27x3	41	75.0	50.5	38.0	141.5	60.0	26.0	-
					M30x3.5	46	80.0	50.5	41.0	144.5	60.0	28.0	-
					M33x3.5	50	84.0	62.0	44.0	147.5	70.0	30.0	-
					M36x4	55	88.5	67.0	47.0	150.5	63.0	33.0	-
					1" 8UN	1-5/8"	75.0	50.5	38.0	141.5	60.0	30.0	-
					1-1/8" 8UN	1-13/16"	80.0	55.5	41.0	144.5	60.0	33.0	-
					1-1/4" 8UN	2"	84.0	62.0	44.0	147.5	70.0	36.0	-
DBS-3	1,500	660	10	4,400	M33x3.5	50	92.0	62.0	44.0	149.5	65.0	30.0	-
					M36x4	55	96.0	67.5	47.0	152.5	63.0	33.0	-
					M39x4	60	105.0	73.5	50.5	156.0	68.0	35.5	-
					M42x4.5	65	104.5	79.0	53.5	159.0	59.0	38.0	-
					1-1/4" 8UN	2"	92.0	62.0	44.0	149.5	65.0	36.0	-
					1-3/8" 8UN	2-3/16"	96.0	67.5	47.0	152.5	63.0	39.0	-
					1-1/2" 8UN	2-3/8"	105.0	73.5	50.5	156.0	68.0	42.5	-
DBS-4	1,500	1,000	10	6,669	M39x4	60	112.0	73.0	50.5	163.5	64.0	35.5	-
					M42x4.5	65	114.0	79.0	53.5	166.5	67.0	38.0	-
					M45x4.5	70	126.0	84.5	57.0	170.0	69.0	40.0	-
					M48x5	75	123.0	89.5	60.0	173.0	68.0	42.0	-
					1-1/2" 8UN	2-3/8"	112.0	73.0	50.5	163.5	64.0	42.5	-
					1-5/8" 8UN	2-9/16"	114.0	79.0	53.5	166.5	67.0	45.5	-
					1-3/4" 8UN	2-3/4"	126.0	84.5	57.0	170.0	69.0	49.0	-
					1-7/8" 8UN	2-15/16"	123.0	89.5	60.0	173.0	68.0	52.0	-
DBS-5	1,500	1,500	10	10,002	M39x4	60	112.0	73.0	50.5	163.5	64.0	35.5	-
					M42x4.5	65	114.0	79.0	53.5	166.5	67.0	38.0	-
					M45x4.5	70	126.0	84.5	57.0	170.0	69.0	40.0	-
					M48x5	75	123.0	89.5	60.0	173.0	68.0	42.0	-
					1-1/2" 8UN	2-3/8"	112.0	73.0	50.5	163.5	64.0	42.5	-
					1-5/8" 8UN	2-9/16"	114.0	79.0	53.5	166.5	67.0	45.5	-
					1-3/4" 8UN	2-3/4"	126.0	84.5	57.0	170.0	69.0	49.0	-
					1-7/8" 8UN	2-15/16"	123.0	89.5	60.0	173.0	68.0	52.0	-
					2" 8UN	3-1/8"	128.0	95.5	63.0	176.0	61.0	55.0	-
					M52x5	80	134.0	95.5	63.0	187.0	61.0	46.0	120.0
DBS-6	1,500	2,500	10	16,670	M56x5.5	85	148.0	106.5	69.5	193.5	60.0	49.0	138.0
					M60x5.5	90	148.0	106.5	69.5	193.5	60.0	52.0	138.0
					M64x6	95	153.0	118.0	76.0	200.0	60.0	55.0	138.0
					M68x6	100	153.0	118.0	76.0	200.0	60.0	58.0	138.0
					M70x6	102	153.0	118.0	76.0	200.0	60.0	58.0	138.0
					2" 8UN	3-1/8"	134.0	95.5	63.0	187.0	61.0	55.0	120.0
					2-1/4" 8UN	3-1/2"	148.0	106.5	69.5	193.5	60.0	61.5	138.0
					2-1/2" 8UN	3-7/8"	153.0	118.0	76.0	200.0	60.0	68.0	138.0
					2-3/4" 8UN	4-1/4"	165.0	129.5	82.0	206.0	60.0	74.0	156.0
					M72x6	105	172.0	129.5	82.0	216.0	60.0	62.0	157.0
DBS-7	1,500	3,200	10	21,336	M76x6	110	182.0	140.0	89.0	223.0	64.0	65.0	157.0
					M80x6	115	182.0	140.0	89.0	223.0	64.0	68.0	157.0
					M85x6	121	190.0	151.0	95.0	229.0	60.0	72.0	157.0
					M90x6	130	205.0	163.0	101.0	235.0	60.0	76.0	157.0
					2-3/4" 8UN	4-1/4"	172.0	129.5	82.0	216.0	60.0	74.0	157.0
					3" 8UN	4-5/8"	182.0	140.0	89.0	223.0	64.0	81.0	157.0
					3-1/4" 8UN	5"	190.0	151.0	95.0	229.0	60.0	87.0	157.0
					3-1/2" 8UN	5-3/8"	205.0	163.0	101.0	235.0	60.0	93.0	157.0
DBS-8	1,500	4,100	10	27,336	M90x6	130	230.0	163.0	101.0	241.0	60.0	76.0	200.0
					M95x6	135	230.0	163.0	101.0	241.0	60.0	80.0	200.0
					M100x6	146	235.0	174.0	107.0	247.0	60.0	84.0	200.0
					3-1/2" 8UN	5-3/8"	230.0	163.0	101.0	241.0	60.0	93.0	200.0
					3-3/4" 8UN	5-3/4"	235.0	174.0	107.0	247.0	60.0	99.0	200.0
					4" 8UN	6-1/8"	242.0	185.0	114.0	254.0	60.0	106.0	210.0
DBS-8	1,500	4,100	10	27,336	M105x6	150	255.0	185.0	114.0	264.0	60.0	88.0	210.0
					M110x6	155	255.0	185.0	114.0	264.0	60.0	92.0	210.0
					M115x6	165	260.0	197.0	120.0	270.0	60.0	96.0	224.0
					4" 8UN	6-1/8"	255.0	185.0	114.0	264.0	60.0	106.0	210.0
					4-1/4" 8UN	6-1/2"	260.0	197.0	120.0	270.0	60.0	112.0	224.0
4-1/2" 8UN	6-7/8"	270.0	207.0	127.0	277.0	60.0	119.0	232.0					

M (mm)	V (mm)	W (mm)	X (mm)	Y $\varnothing$ (mm)	Z $\varnothing$ (mm)	Tommy Bar $\varnothing$ (mm)
25.0	-	-	-	-	-	10.0
25.0	-	-	-	-	-	10.0
25.0	-	-	-	-	-	10.0
25.0	-	-	-	-	-	10.0
31.0	8.8	37.5	78.5	67.0	85.0	10.0
31.0	8.8	37.5	78.5	67.0	85.0	10.0
31.0	8.8	37.5	78.5	67.0	85.0	10.0
31.0	8.8	37.5	78.5	67.0	85.0	10.0
30.0	11.8	37.5	78.5	82.0	103.0	10.0
30.0	11.8	37.5	78.5	82.0	103.0	10.0
30.0	11.8	37.5	78.5	82.0	103.0	10.0
35.0	11.8	37.5	78.5	82.0	103.0	10.0
35.0	11.8	37.5	78.5	82.0	103.0	10.0
30.0	11.8	37.5	78.5	82.0	103.0	10.0
30.0	11.8	37.5	78.5	82.0	103.0	10.0
35.0	11.8	37.5	78.5	82.0	103.0	10.0
38.0	11.8	37.5	78.5	82.0	103.0	10.0
35.0	12.75	37.5	78.5	96.0	118.0	10.0
38.0	12.75	37.5	78.5	96.0	118.0	10.0
42.0	12.75	37.5	78.5	96.0	118.0	10.0
41.0	12.75	37.5	78.5	96.0	118.0	10.0
35.0	12.75	37.5	78.5	96.0	118.0	10.0
38.0	12.75	37.5	78.5	96.0	118.0	10.0
42.0	12.75	37.5	78.5	96.0	118.0	10.0
41.0	12.75	37.5	78.5	96.0	118.0	10.0
42.0	12.75	40.0	81.0	110.0	140.5	10.0
45.0	12.75	40.0	81.0	110.0	140.5	10.0
52.0	12.75	40.0	81.0	110.0	140.5	10.0
51.0	12.75	40.0	81.0	110.0	140.5	10.0
42.0	12.75	40.0	81.0	110.0	140.5	10.0
45.0	12.75	40.0	81.0	110.0	140.5	10.0
52.0	12.75	40.0	81.0	110.0	140.5	10.0
51.0	12.75	40.0	81.0	110.0	140.5	10.0
52.0	12.75	40.0	81.0	110.0	140.5	10.0
52.0	14.5	41.0	85.0	140.0	175.5	14.0
58.0	14.5	41.0	85.0	140.0	175.5	14.0
58.0	14.5	41.0	85.0	140.0	175.5	14.0
63.0	14.5	41.0	85.0	140.0	175.5	14.0
63.0	14.5	41.0	85.0	140.0	175.5	14.0
63.0	14.5	41.0	85.0	140.0	175.5	14.0
52.0	14.5	41.0	85.0	140.0	175.5	14.0
58.0	14.5	41.0	85.0	140.0	175.5	14.0
63.0	14.5	41.0	85.0	140.0	175.5	14.0
70.0	14.5	41.0	85.0	140.0	175.5	14.0
72.0	14.5	41.0	85.0	180.0	219.0	14.0
80.0	14.5	41.0	85.0	180.0	219.0	14.0
80.0	14.5	41.0	85.0	180.0	219.0	14.0
84.0	14.5	41.0	85.0	180.0	219.0	14.0
88.0	14.5	41.0	85.0	180.0	219.0	14.0
72.0	14.5	41.0	85.0	180.0	219.0	14.0
80.0	14.5	41.0	85.0	180.0	219.0	14.0
84.0	14.5	41.0	85.0	180.0	219.0	14.0
88.0	14.5	41.0	85.0	180.0	219.0	14.0
88.0	45.0	41.0	85.0	200.0	252.0	14.0
88.0	45.0	41.0	85.0	200.0	252.0	14.0
94.0	45.0	41.0	85.0	200.0	252.0	14.0
88.0	45.0	41.0	85.0	200.0	252.0	14.0
94.0	45.0	41.0	85.0	200.0	252.0	14.0
114.0	45.0	41.0	85.0	200.0	252.0	14.0
114.0	45.0	41.0	85.0	218.0	283.0	14.0
114.0	45.0	41.0	85.0	218.0	283.0	14.0
114.0	45.0	41.0	85.0	218.0	283.0	14.0
114.0	45.0	41.0	85.0	218.0	283.0	14.0
114.0	45.0	41.0	85.0	218.0	283.0	14.0
117.0	45.0	41.0	85.0	218.0	283.0	14.0

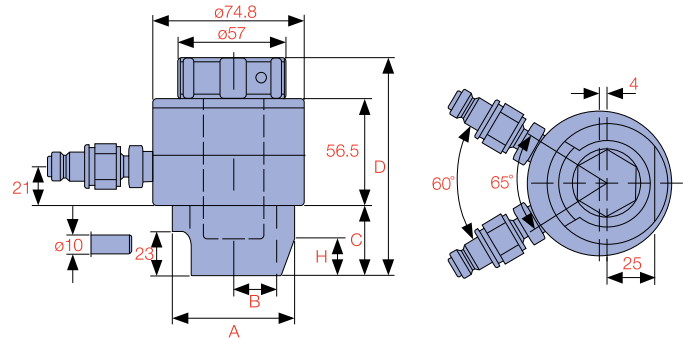

**DBS-0**

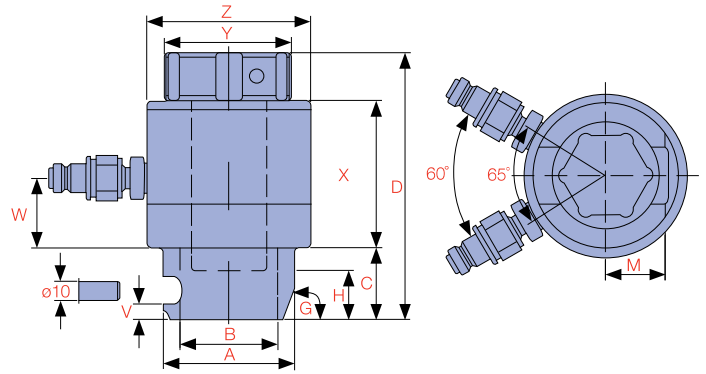

**DBS-1, DBS-2, DBS-3 & DBS-4**

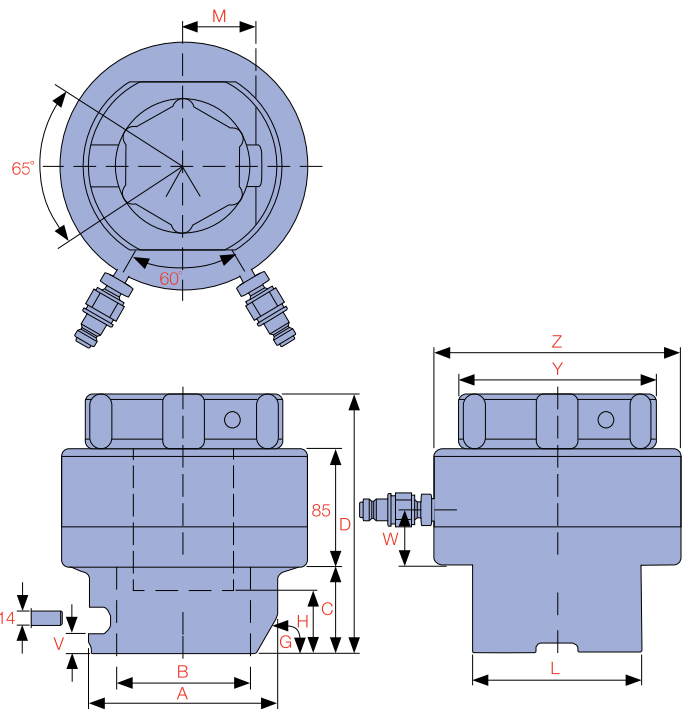

**DBS-5, DBS-6, DBS-7 & DBS-8**

## HYDRAULIC BOLT TENSIONERS

BOLTING SOLUTIONS



### How to order...

For greater flexibility Tension Adaptor Kits are ordered separately.

- 1) Select appropriate Load Cell
- 2) Select appropriate Tension Adaptor Kit based on bolt diameter and AF size
- 3) Create order for complete unit e.g.  
 1 x **DBS-4** Load Cell  
 1 x **DBS4-M42x4.5** Tension Adaptor Kit

### Metric - Tension Adaptor Kit Sizing

Bolt Diameter (mm)	AF Size	DBS-0	DBS-1	DBS-2	DBS-3	DBS-4	DBS-5	DBS-6	DBS-7	DBS-8
		160 kN	280 kN	450 kN	660 kN	1,000 kN	1,500 kN	2,500 kN	3,200 kN	4,100 kN
M20x2.5	30	M20x2.5 (30)								
M22x2.5	32	M22x2.5 (32)								
M24x3	36		M24x3 (36)	M24x3 (36)						
M27x3	41		M27x3 (41)	M27x3 (41)						
M30x3.5	46			M30x3.5 (46)						
M33x3.5	50			M33x3.5 (50)	M33x3.5 (50)					
M36x4	55			M36x4 (55)	M36x4 (55)					
M39x4	60				M39x4 (60)	M39x4 (60)				
M42x4.5	65				M42x4.5 (65)	M42x4.5 (65)				
M45x5	70					M45x4.5 (70)				
M48x5	75					M48x5 (75)				
M52x5.5	80						M52x5 (80)			
M56x5.5	85						M56x5.5 (85)			
M60x5.5	90						M60x5.5 (90)			
M64x6	95						M64x6 (95)			
M68x6	100						M68x6 (100)			
M70x6	100						M70x6 (100)			
M72x6	105							M72x6 (105)		
M76x6	110							M76x6 (110)		
M80x6	115							M80x6 (115)		
M85x6	120							M85x6 (120)		
M90x6	130							M90x6 (130)	M90x6 (130)	
M95x6	135								M95x6 (135)	
M100x6	145								M100x6 (145)	
M105x6	150									M105x6 (150)
M110x6	155									M110x6 (155)
M115x6	165									M115x6 (165)

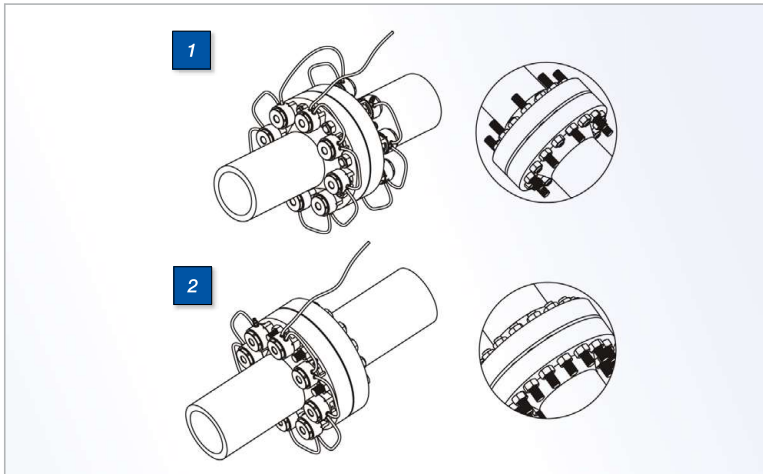

### Tensioning

Not all applications allow for the simultaneous fit of a tensioning device on each bolt, in these cases at least two tensioning pressures are applied.

- 1) Setup using a 100% tensioning procedure
- 2) Setup using a 50% tensioning procedure

Manufacturer's rating of pressure and torque are maximum safe limits. Good practice encourages using only 80% of these ratings

### Imperial - Tension Adaptor Kit Sizing

Bolt Diameter (inch)	AF Size	DBS-0	DBS-1	DBS-2	DBS-3	DBS-4	DBS-5	DBS-6	DBS-7	DBS-8
		160 kN	280 kN	450 kN	660 kN	1,000 kN	1,500 kN	2,500 kN	3,200 kN	4,100 kN
3/4" 10UN	1-1/4"	3/4" 10UN (1-1/4")								
7/8" 9UN	1-7/16"	7/8" 9UN (1-7/16")								
1" 8UN	1-5/8"		1" 8UN (1-5/8")	1" 8UN (1-5/8")						
1 1/8" 8UN	1-13/16"		1 1/8" 8UN (1-13/16")	1 1/8" 8UN (1-13/16")						
1 1/4" 8UN	2"			1 1/4" 8UN (2")	1 1/4" 8UN (2")					
1 3/8" 8UN	2-3/16"			1 3/8" 8UN (2-3/16")	1 3/8" 8UN (2-3/16")					
1 1/2" 8UN	2-3/8"				1 1/2" 8UN (2-3/8")	1 1/2" 8UN (2-3/8")				
1 5/8" 8UN	2-9/16"				1 5/8" 8UN (2-9/16")	1 5/8" 8UN (2-9/16")				
1 3/4" 8UN	2-3/4"					1 3/4" 8UN (2-3/4")				
1 7/8" 8UN	2-15/16"					1 7/8" 8UN (2-15/16")				
2" 8UN	3-1/8"					2" 8UN (3-1/8")	2" 8UN (3-1/8")			
2 1/4" 8UN	3-1/2"						2 1/4" 8UN (3-1/2")			
2 1/2" 8UN	3-7/8"						2 1/2" 8UN (3-7/8")			
2 3/4" 8UN	4-1/4"						2 3/4" 8UN (4-1/4")	2 3/4" 8UN (4-1/4")		
3" 8UN	4-5/8"							3" 8UN (4-5/8")		
3 1/4" 8UN	5"							3 1/4" 8UN (5")		
3 1/2" 8UN	5-3/8"							3 1/2" 8UN (5-3/8")	3 1/2" 8UN (5-3/8")	
3 3/4" 8UN	5-3/4"								3 3/4" 8UN (5-3/4")	
4" 8UN	6-1/8"								4" 8UN (6-1/8")	4" 8UN (6-1/8")
4-1/4" 8UN	6-1/2"									4-1/4" 8UN (6-1/2")
4-1/2" 8UN	6-7/8"									4-1/2" 8UN (6-7/8")

THREAD ADAPTOR

LOAD CELL

BRIDGE AND SOCKET

CROSS SECTIONAL



T

BOLTING SOLUTIONS

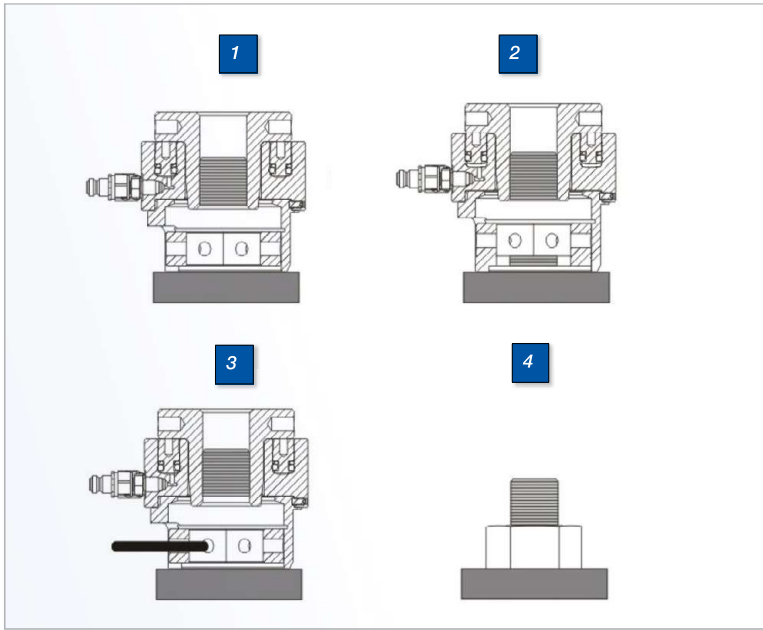

### Tensioner Instructions

- 1) The bolt tensioner is fitted over the stud
- 2) Hydraulic pressure is applied to the tensioner which then stretches the stud
- 3) The stud's nut is wound down against the joint face
- 4) Pressure is released and the tool removed



### Advantages of Lubrication

- 1) Reduces the friction during tightening
- 2) Increases bolt service life
- 3) Decreases bolt failure during installation
- 4) Higher friction results in less conversion of torque to preload

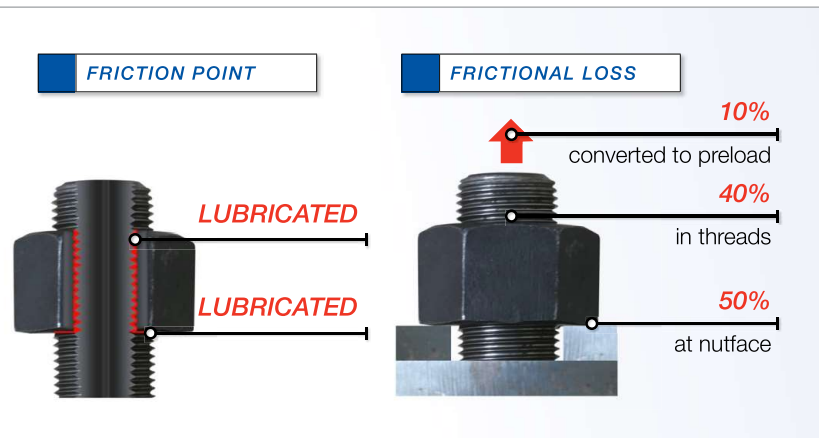

Pressure (bar)	DBS-0 kN	DBS-1 kN	DBS-2 kN	DBS-3 kN	DBS-4 kN	DBS-5 kN	DBS-6 kN	DBS-7 kN	DBS-8 kN	Pressure (psi)
100	1,067	1,867	3,003	4,400	6,669	10,002	16,670	21,336	27,336	1,450
200	2,134	3,734	6,006	8,800	13,338	20,004	33,340	42,672	54,672	2,901
300	3,201	5,601	9,009	13,200	20,007	30,006	50,010	64,008	82,008	4,351
400	4,268	7,468	12,012	17,600	26,676	40,008	66,680	85,344	109,344	5,801
500	5,335	9,335	15,015	22,000	33,345	50,010	83,350	106,680	136,680	7,252
600	6,402	11,202	18,018	26,400	40,014	60,012	100,020	128,016	164,016	8,702
700	7,469	13,069	21,021	30,800	46,683	70,014	116,690	149,352	191,352	10,152
800	8,536	14,936	24,024	35,200	53,352	80,016	133,360	170,688	218,688	11,603
900	9,603	16,803	27,027	39,600	60,021	90,018	150,030	192,024	246,024	13,053
1,000	10,670	18,670	30,030	44,000	66,690	100,020	166,700	213,360	273,360	14,503
1,100	11,737	20,537	33,033	48,400	73,359	110,022	183,370	234,696	300,696	15,954
1,200	12,804	22,404	36,036	52,800	80,028	120,024	200,040	256,032	328,032	17,404
1,300	13,871	24,271	39,039	57,200	86,697	130,026	216,710	277,368	355,368	18,854
1,400	14,938	26,138	42,042	61,600	93,366	140,028	233,380	298,704	382,704	20,305
1,500	16,005	28,005	45,045	66,000	100,035	150,030	250,050	320,040	410,040	21,755





The DBTP-1500K is made up of P-2100H Hand Pump, FGA-2 Gauge Adaptor and PG-100-40K Pressure Gauge. This kit is ideal for single stud or small to medium bolt tensioning applications.

**PG-100-40K**  
Liquid Filled Pressure Gauge

**P-2100H**  
2 Speed, 2 Way Hand Pump with Relief Valve set at 1,500 bar

**FGA-2**  
Gauge Adaptor (includes gauge and pump connectors)  
Outlet thread is 9/16" - 18UNF female thread with 60° internal cone (1/4" HP)

**PRESSURE RATING**  
1st stage 28 bar, 2nd stage 1,500 bar



**MAX. HANDLE EFFORT**  
25 kg



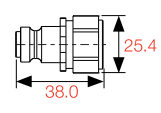

**USABLE OIL**  
1 Litre

**OIL PORT THREAD**  
3/4" - 16UNF

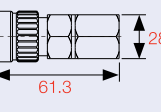
**DBTP-1500K / 1,500 bar Hand Pump Kit**

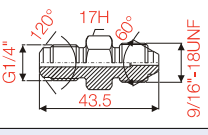
**F**  
BOLTING SOLUTIONS

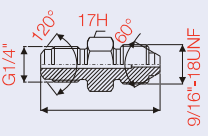
Model Number	Dimensions (mm)	Description	Dimensions
 DBT116M Quick Release Nipple		Max. W.P. 150 MPa Min. B.P. 300 MPa Flow at 0.4 MPa pressure 6.0 Lpm	Connect: G1/4" Weight: 60 g Rec. Torque: 40 - 50 Nm Hexagon key handle: 22
 DBT116F Quick Release Coupler		Max. W.P. 150 MPa Min. B.P. 300 MPa Flow at 0.4 MPa pressure 6.0 Lpm	Connect: G1/4" Weight: 165 g Rec. Torque: 40 - 50 Nm Hexagon key handle: 24

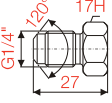
Model Number	Dimensions (mm)	End One	End Two
 DBT14129166I		G1/4" 120°	9/16" - 18UNF male thread with 60° internal cone
 DBT14129166E		G1/4" male thread with 120° external cone	9/16" - 18UNF male thread with 60° external cone
 DBT1412SP		G1/4" male thread with 120° external cone	-

Model Number	Description	End One	End Two
 DBTH-05A*	Inner core: Polyoxymethylene (POM) Outer cover: Polyamide (PA) 4 layers of high-tensile steel wire Inside Diameter: 5.0mm, Outside Diameter: 11.2mm Working Pressure: 1,800bar, Burst Pressure: 4,500bar Minimum Bend Radius: 150mm Weight: 0.26 kg/M	G1/4" Male	G1/4" Male

\* Confirm hose length in metres when ordering