

THE **PR & PS-SERIES** PULLERS ARE A CONVERTIBLE 2 OR 3 WAY UNIT FOR A ONE PERSON OPERATION.

Available in remote and self-contained versions from 4-30 ton capacity. The PS-Series 3 in 1 puller is a double acting unit designed for pushing, outer pulling and inner pulling.

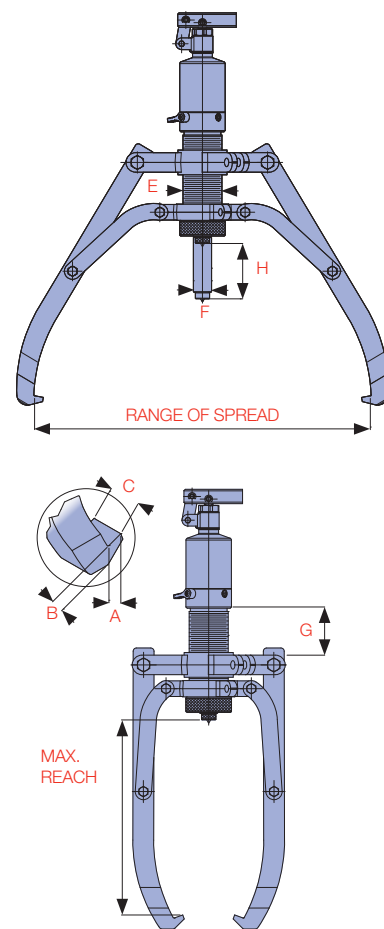
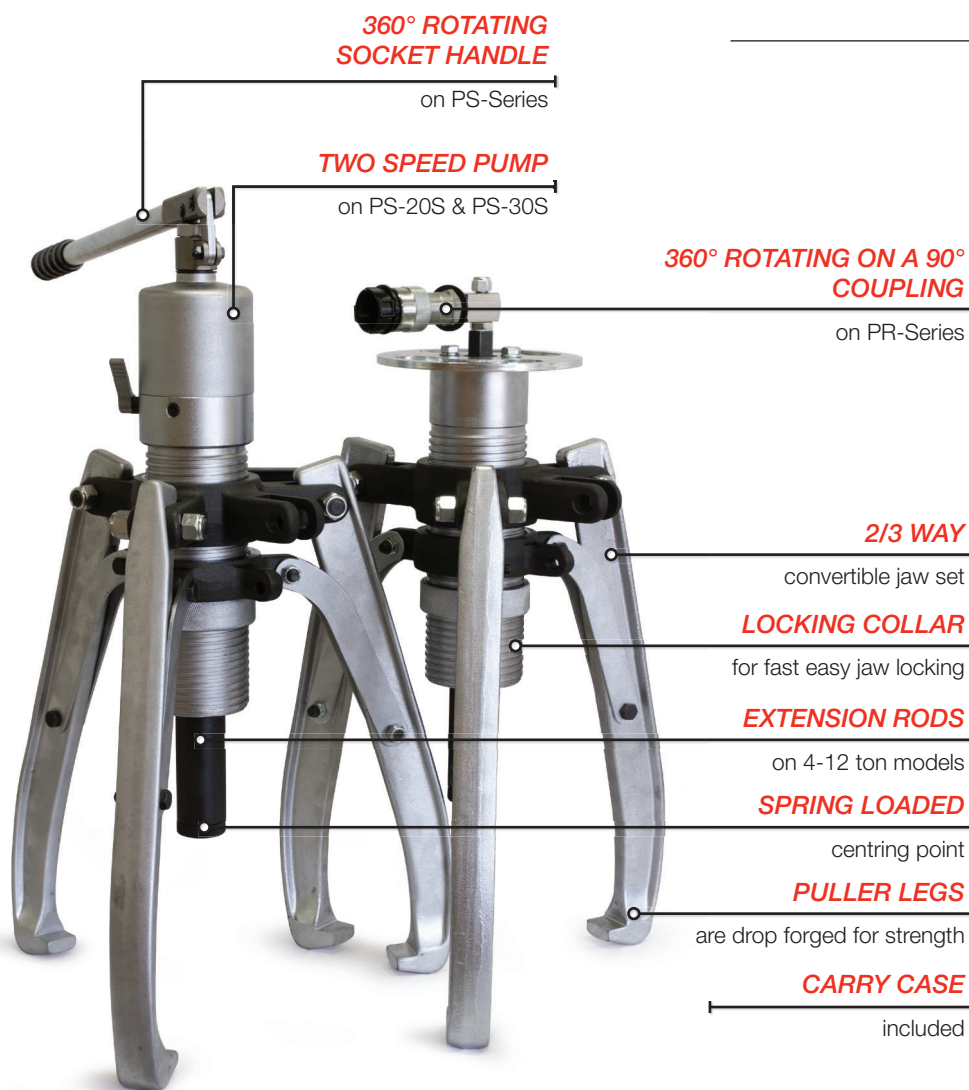

| Model No. | Puller Type    | Capacity (ton) | Max. Reach (mm) | Range of Spread (mm) | Extension Rods | Jaw Tip (mm) |      |      | Hydraulic Cylinder (mm) |    |    | Stroke (mm) | Weight (kg) |
|-----------|----------------|----------------|-----------------|----------------------|----------------|--------------|------|------|-------------------------|----|----|-------------|-------------|
|           |                |                |                 |                      | 58 mm - Qty    | A            | B    | C    | E                       | F  | G  |             |             |
| PR-04     | Remote         | 4              | 190             | 67.5 - 325           | 2              | 13           | 10   | 22   | 42                      | 22 | 40 | 60          | 6           |
| PS-04S    | Self-contained |                | 190             | 67.5 - 325           | 2              | 13           | 10   | 22   | 42                      | 22 | 40 | 60          | 8           |
| PR-08     | Remote         | 8              | 280             | 107.0 - 450          | 3              | 13           | 13   | 27.5 | 50                      | 25 | 70 | 85          | 9           |
| PS-08S    | Self-contained |                | 280             | 107.0 - 450          | 3              | 13           | 13   | 27.5 | 50                      | 25 | 70 | 85          | 12          |
| PR-12     | Remote         | 12             | 305             | 94.5 - 485           | 4              | 15           | 16.5 | 29   | 60                      | 28 | 70 | 85          | 12          |
| PS-12S    | Self-contained |                | 305             | 94.5 - 485           | 4              | 15           | 16.5 | 29   | 60                      | 28 | 70 | 85          | 15          |
| PR-20     | Remote         | 20             | 365             | 128.4 - 570          | -              | 20           | 27   | 33   | 80                      | 40 | 62 | 111         | 24          |
| PS-20S    | Self-contained |                | 365             | 128.4 - 570          | -              | 20           | 27   | 33   | 80                      | 40 | 62 | 111         | 26          |
| PR-30     | Remote         | 30             | 465             | 128.5 - 680          | -              | 20           | 27   | 38   | 98                      | 50 | 85 | 111         | 34          |
| PS-30S    | Self-contained |                | 465             | 128.5 - 680          | -              | 20           | 27   | 38   | 98                      | 50 | 85 | 111         | 36          |

### SELF-CONTAINED HAND PUMP

rotates 360°

### DOUBLE ACTING CYLINDER

allows for pushing/outer pulling and inner pulling

### VARIABLE HEIGHT

extension legs

### 3 JAW STRUCTURE

provides even force

### STEEL CARRY CASE

included

### INTERNAL PULLER

allows removal of oil seals, bushings and bearings



CAPACITY RANGE

**4 - 30 ton**

MAXIMUM OPERATING PRESSURE

**700 bar**

G

HYDRAULIC TOOLS

*This patented double acting design provides the operator with a 3 in 1 tool for installing, outer and inner pulling with convenience and safety.*

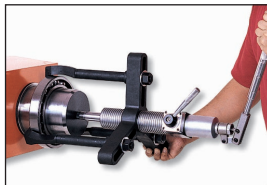
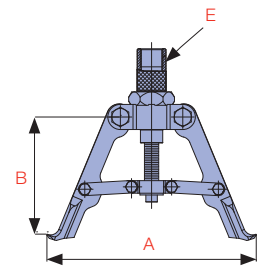
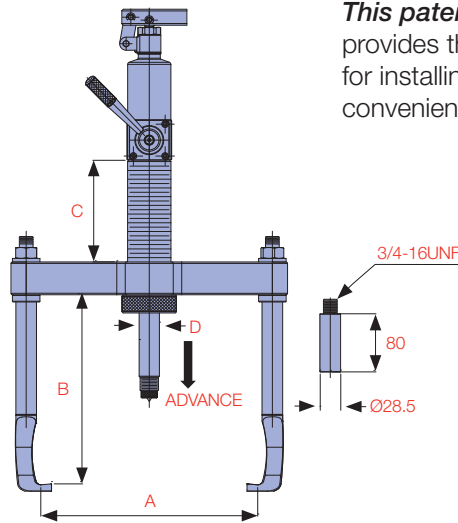
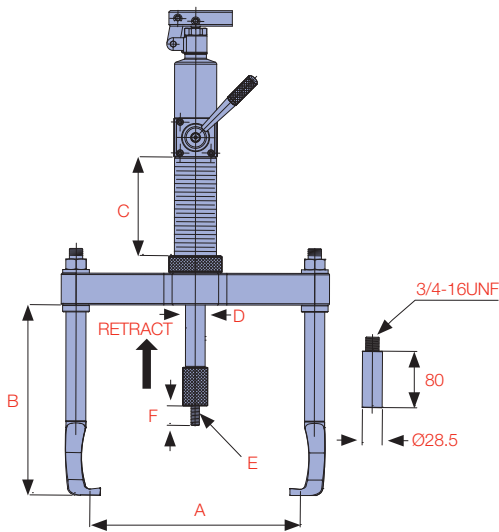

FOR OUTER PULLING



FOR OUTER/INNER INSTALLING



INNER PULLING ATTACHMENT

| Model No. | Puller Type   | Capacity (ton) | A (mm)    | B (mm)    | C (mm) | D (mm) | E          | F (mm) | Weight (kg) |
|-----------|---------------|----------------|-----------|-----------|--------|--------|------------|--------|-------------|
| PS-1208D  | Installing    | 8              | 44 - 280  | 270 + 80  | 140    | 28     | M12 x 1.75 | 30     | 19.5        |
|           | Outer Pulling | 12             | 85 - 300  | 260 + 80  | 140    | 28     | -          | -      |             |
|           | Inner Pulling | 8              | 110 - 210 | 130 - 150 | -      | -      | 1"-12UNF   | -      |             |

THE **ET-SERIES** TRI-SECTIONAL PLATES ARE SPECIALLY DESIGNED FOR USE WITH THE PR & PS-SERIES PULLERS.

The unique and patented swing design creates the maximum spread and provides the most even force. The plates grip behind the inner and outer rings of the bearing together which prevents the pulling force from being transmitted through the rolling parts, minimising the risk of bearing damage.



Swivel point allows widespread

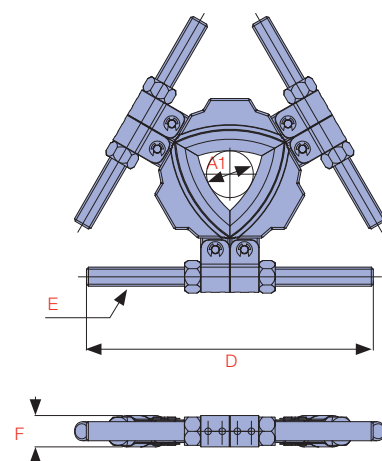
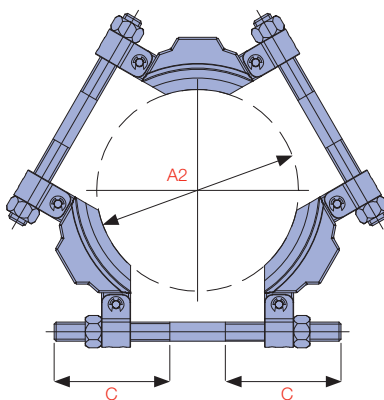
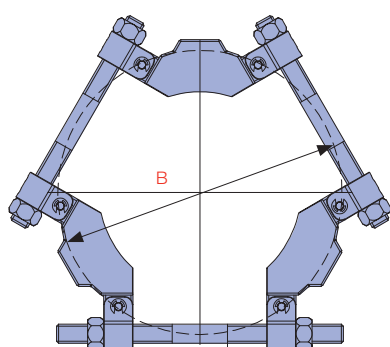

| Model No. | Rated Capacity (ton) | Shaft Diameter |           | B Max. Spread (mm) | C (mm) | D (mm) | E            | F (mm) | Compatible PR/PS Puller* | Weight (kg) |
|-----------|----------------------|----------------|-----------|--------------------|--------|--------|--------------|--------|--------------------------|-------------|
|           |                      | A1 (Min.)      | A2 (Max.) |                    |        |        |              |        |                          |             |
| ET3-210   | 8                    | 50             | 210       | 280                | 117    | 285    | 7/8"-14UNF   | 31     | PR-08, PS-08S, PS-1208D  | 5.5         |
| ET3-340   | 20                   | 90             | 340       | 460                | 175    | 460    | 1 1/4"-12UNF | 47     | PR-20, PS-20S            | 18.0        |
| ET3-495   | 30                   | 140            | 495       | 660                | 235    | 660    | 1 3/4"-12UNF | 63     | PR-30, PS-30S            | 45.0        |

\* PR/PS Puller Cylinder not included in Set

THE **BS-SERIES** CROSS BEARING ATTACHMENTS PROVIDE A KNIFE-LIKE EDGE TO GET BEHIND PARTS FOR ADDED VERSATILITY AND SECURE REMOVAL OF PARTS.

Great for parts that do not offer adequate grip with jaw type pullers. All bearing/pulley attachments include the bearing attachment, a pair of sized thread-in legs and a sliding cross head. Simply add the hydraulic cylinder from your PR/PS-Series puller set.

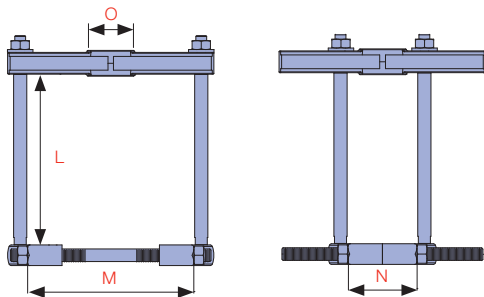
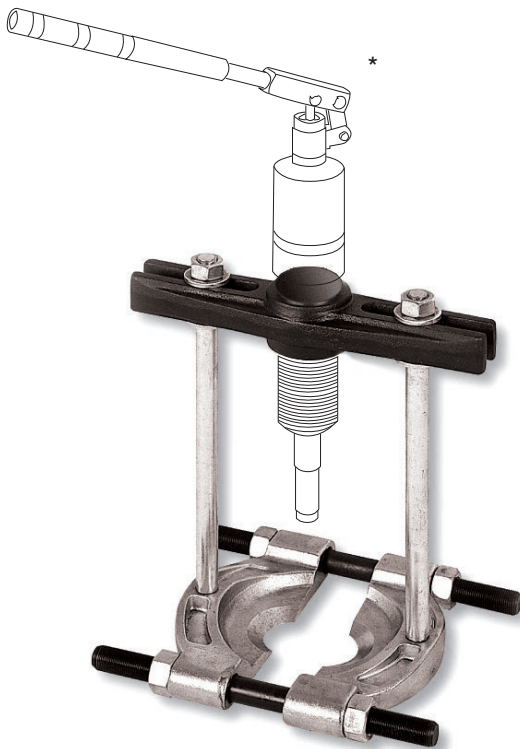

**BEARING/PULLER ATTACHMENT SET\***



CAPACITY RANGE

**4 - 30 ton**

SPREAD RANGE

**5 - 495 mm**

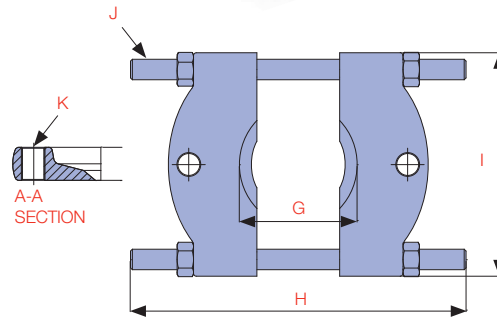

**CROSS BEARING ATTACHMENTS**

| Model No. | G<br>(Min./Max.) | H<br>(mm) | I<br>(mm) | J          | K          | Weight<br>(kg) |
|-----------|------------------|-----------|-----------|------------|------------|----------------|
| BS-5-60   | 5 - 60           | 125       | 70        | 3/8"-24UNF | 3/8"-16UNC | 0.6            |
| BS-15-60  | 15 - 60          | 135       | 127       | 1/2"-20UNF | 3/8"-16UNC | 1.4            |
| BS-12-70  | 12 - 70          | 163       | 156       | 5/8"-18UNF | 1/2"-12UNC | 2.5            |
| BS-28-150 | 28 - 150         | 260       | 204       | 3/4"-16UNF | 5/8"-11UNC | 5.5            |
| BS-20-200 | 20 - 200         | 350       | 288       | 1"-14UN    | 3/4"-10UNC | 8.5            |

| Model No. | Capacity<br>(ton) | Reach<br>L<br>(mm) | Spread    |           |           | Inc. Bearing<br>Attachment | Compatible PR/PS Puller* | Weight<br>(kg) |
|-----------|-------------------|--------------------|-----------|-----------|-----------|----------------------------|--------------------------|----------------|
|           |                   |                    | M<br>(mm) | N<br>(mm) | O<br>(mm) |                            |                          |                |
| BS-04250  | 4                 | 250                | 110       | 55        | 42        | BS-12-70                   | PR-04, PS-04S            | 6.5            |
| BS-08270  | 8                 | 270                | 220       | 95        | 50        | BS-28-150                  | PR-08, PS-08S            | 9.5            |
| BS-12380  | 12                | 380                | 290       | 225       | 60        | BS-20-200                  | PR-12, PS-12S, PS-1208D  | 13.0           |

\* PR/PS Puller Cylinder not included in Set

**G**

**HYDRAULIC TOOLS**