

THE **RJ-SERIES** IS A SINGLE ACTING SPRING RETURN CYLINDER. IT IS IDEALLY SUITED TO JACKING, TESTING, WEIGHING AND GENERAL MAINTENANCE APPLICATIONS THAT REQUIRE A HIGH TONNAGE SHORT STROKE CYLINDER DESIGN IN CAPACITIES BEYOND THE 100 TON RLP SERIES.

All RJ-Series cylinders feature a hard chrome cylinder bore and piston rod for maximum corrosion resistance and bronze overlay piston bearing area to reduce scoring and increase service life. Removable hardened load caps are standard.



**EXCEEDS**  
ANSI/ASME B30.1  
**SAFETY**  
STANDARDS

RJ-1502

Model Number	Cylinder Capacity ton* / kN		Stroke (mm)	Cylinder Effective Area (cm <sup>2</sup> )	Oil Capacity (cm <sup>3</sup> )	A Collapsed Height (mm)	B Extended Height (mm)	D Outside Diameter (mm)
RJ-1502	150	1,407	50	201.0	1,005	200	250	215
RJ-1504		1,407	100	201.0	2,010	250	350	215
RJ-2002	200	1,984	50	283.4	1,417	200	250	255
RJ-2004		1,984	100	283.4	2,834	250	350	255

\* Nominal Cylinder Capacity in ton - see kN values for actual capacity

### POWDER COATED FINISH

enhances appearance and reduces corrosion

### HARD CHROME PLATED BORE

for maximum corrosion resistance and cylinder life

### HARD CHROME PLATED PISTON ROD

for maximum corrosion resistance and cylinder life

### RETURN SPRING

is sized to ensure efficient piston rod return and maximum spring life

### HARDENED GROOVED LOAD CAP

to prevent piston rod damage

### GLAND NUT

with low friction coating withstands full dead end loading

### BRONZE OVERLAY

on piston bearing area reduces side load induced damage and extends cylinder life

### PARKER

industry standard high flow coupling for compatibility

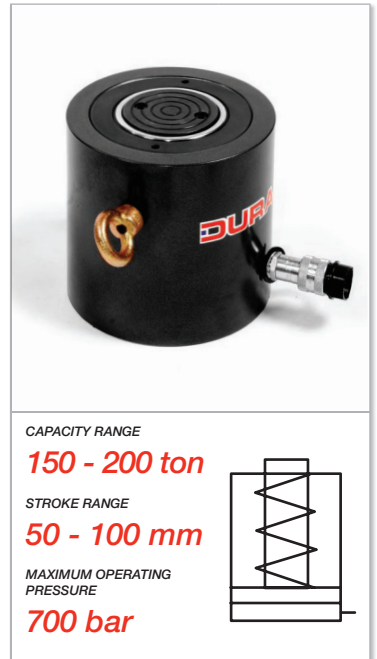

CAPACITY RANGE

**150 - 200 ton**

STROKE RANGE

**50 - 100 mm**

MAXIMUM OPERATING PRESSURE

**700 bar**

C

HYDRAULIC CYLINDERS

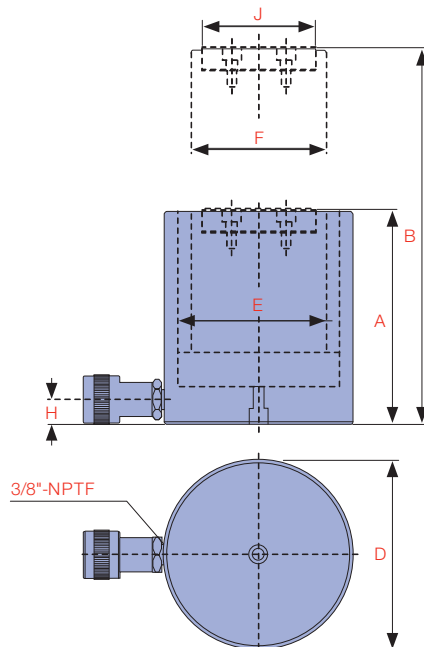

**RLP-Series** cylinders offer short stroke capacities from 10-100 ton



E Cylinder Bore Diameter (mm)	F Piston Rod Diameter (mm)	H Base to Advance Port (mm)	J Standard Load Cap Diameter (mm)	Weight (kg)	Model Number	Handle Type
160	115	50	99	50	RJ-1502	♦ ♥
160	115	50	99	60	RJ-1504	♦ ♥
190	135	50	115	72	RJ-2002	♦ ♥
190	135	50	115	85	RJ-2004	♦ ♥

HANDLE TYPES: ♦ EYEBOLT ♥ REMOVABLE STRAP HANDLE