



THE **RJ-SERIES** IS A SINGLE ACTING SPRING RETURN CYLINDER. IT IS IDEALLY SUITED TO JACKING, TESTING, WEIGHING AND GENERAL MAINTENANCE APPLICATIONS THAT REQUIRE A HIGH TONNAGE SHORT STROKE CYLINDER DESIGN IN CAPACITIES BEYOND THE 100 TON RLP SERIES.

All RJ-Series cylinders feature a hard chrome cylinder bore and piston rod for maximum corrosion resistance and bronze overlay piston bearing area to reduce scoring and increase service life. Removable hardened load caps are standard.



EXCEEDS
ANSI/ASME B30.1
SAFETY
STANDARDS



RJ-1502

Model Number	Cylinder Capacity ton* / max.	Stroke (in)	Cylinder Effective Area (in ²)	Oil Capacity (in ³)	A Collapsed Height (in)	B Extended Height (in)	D Outside Diameter (in)	
RJ-1502	150	158.1	1.97	31.16	61.33	7.87	9.84	8.46
RJ-1504		158.1	3.94	31.16	122.66	9.84	13.78	8.46
RJ-2002	200	223.0	1.97	43.93	86.47	7.87	9.84	10.04
RJ-2004		223.0	3.94	43.93	172.94	9.84	13.78	10.04

* Nominal Cylinder Capacity in ton - see max. values for actual capacity

POWDER COATED FINISH

enhances appearance and reduces corrosion

HARD CHROME PLATED BORE

for maximum corrosion resistance and cylinder life

HARD CHROME PLATED PISTON ROD

for maximum corrosion resistance and cylinder life

RETURN SPRING

is sized to ensure efficient piston rod return and maximum spring life

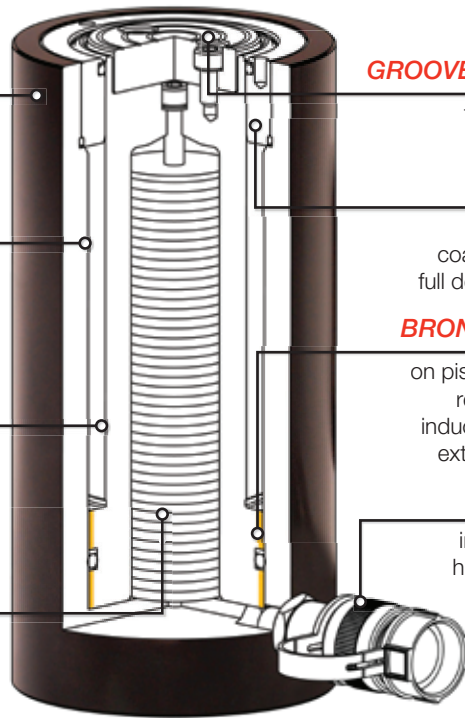

HARDENED GROOVED LOAD CAP

to prevent piston rod damage

GLAND NUT

with low friction coating withstands full dead end loading

BRONZE OVERLAY

on piston bearing area reduces side load induced damage and extends cylinder life

PARKER

industry standard high flow coupling for compatibility

CAPACITY RANGE
150 - 200 ton

STROKE RANGE
1.97 - 3.94 in

MAXIMUM OPERATING PRESSURE
10,150 psi

C
HYDRAULIC CYLINDERS

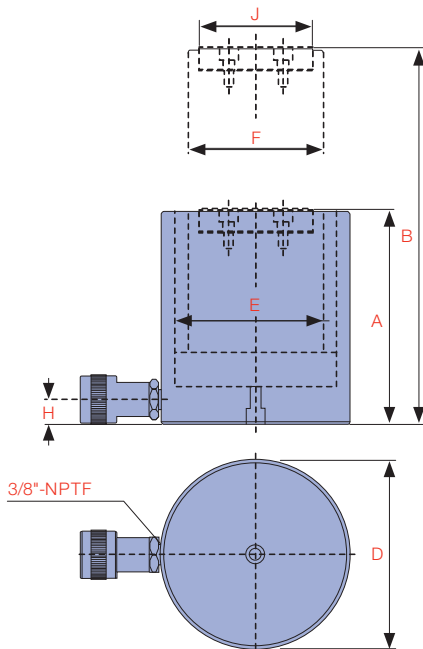

i **RLP-Series** cylinders offer short stroke capacities from 10-100 ton



E Cylinder Bore Diameter (in)	F Piston Rod Diameter (in)	H Base to Advance Port (in)	J Standard Load Cap Diameter (in)	Weight (lbs)	Model Number	Handle Type
6.30	4.53	1.97	3.90	101.3	RJ-1502	◆♥
6.30	4.53	1.97	3.90	121.5	RJ-1504	◆♥
7.48	5.31	1.97	4.53	145.8	RJ-2002	◆♥
7.48	5.31	1.97	4.53	172.2	RJ-2004	◆♥

HANDLE TYPES: ◆ EYEBOLT ♥ REMOVABLE STRAP HANDLE