

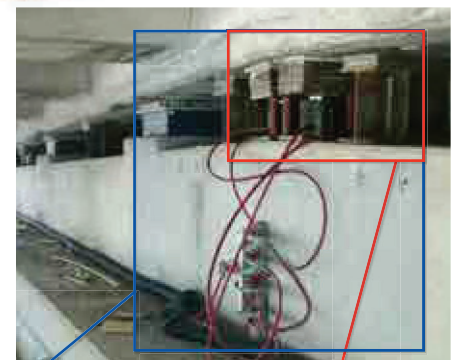

THE **RLP-SERIES** IS A SINGLE ACTING SPRING RETURN LOW PROFILE CYLINDER. ITS COMPACT DESIGN COMBINES MAXIMUM STROKE WITH LOW COLLAPSED HEIGHT.

These cylinders are commonly used in construction, mining, rail and many other industries. They are ideal for jacking, weighing, testing, levelling and general maintenance applications. All RLP-Series cylinders feature a hard chrome cylinder bore and piston rod for maximum corrosion resistance and bronze overlay piston bearing area to reduce scoring and increase service life. Optional TSL tilt saddles are available for all models.



Model Number	Cylinder Capacity ton* / max.		Stroke (in)	Cylinder Effective Area (in <sup>2</sup> )	Oil Capacity (in <sup>3</sup> )	A Collapsed Height (in)	B Extended Height (in)	D Outside Diameter (in)	E Cylinder Bore Diameter (in)	F Piston Rod Diameter (in)
RLP-101	10	11.2	1.50	2.24	3.35	3.47	4.97	2.75	1.69	1.50
RLP-201	20	22.1	1.75	4.43	7.75	3.88	5.63	3.63	2.38	2.00
RLP-302	30	32.4	2.44	6.49	15.82	4.63	7.06	4.00	2.88	2.62
RLP-502	50	48.1	2.38	9.62	22.70	4.81	7.19	4.88	3.50	2.75
RLP-1002	100	98.1	2.25	19.63	44.18	5.56	7.81	6.50	5.00	3.63

\* Nominal Cylinder Capacity in ton - see max. values for actual capacity

### POWDER COATED FINISH

enhances appearance and reduces corrosion

### HARD CHROME PLATED BORE

for maximum corrosion resistance and cylinder life

### BRONZE OVERLAY

on piston bearing area reduces side load induced damage and extends cylinder life

### RETURN SPRING

is sized to ensure efficient piston rod return and maximum spring life

### HARDENED GROOVED LOAD CAP

to prevent piston rod damage. Optional tilt saddles available

### GLAND NUT

with low friction coating withstands full dead end loading

### HARD CHROME PLATED PISTON ROD

for maximum corrosion resistance and cylinder life

### PARKER

industry standard high flow coupling for compatibility

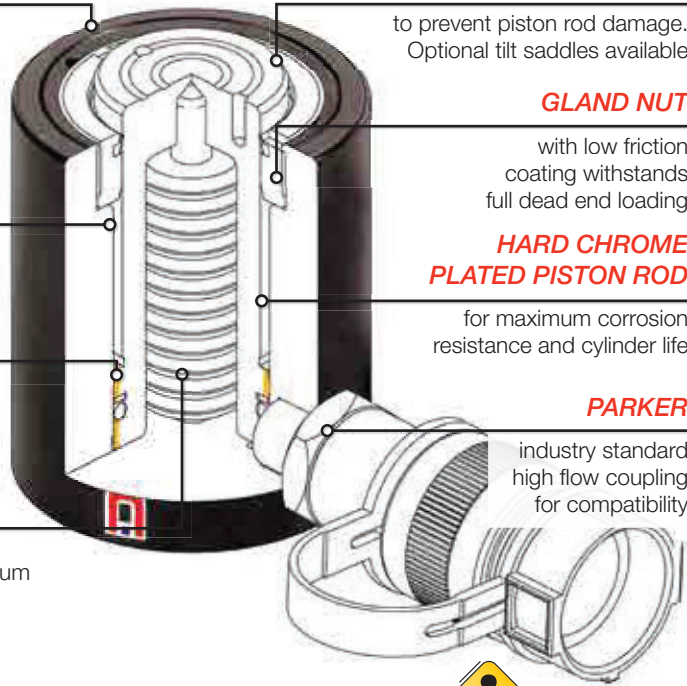

**CAPACITY RANGE**  
**10 - 100 ton**

**STROKE RANGE**  
**1.50 - 2.44 in**

**MAXIMUM OPERATING PRESSURE**  
**10,150 psi**

HYDRAULIC CYLINDERS

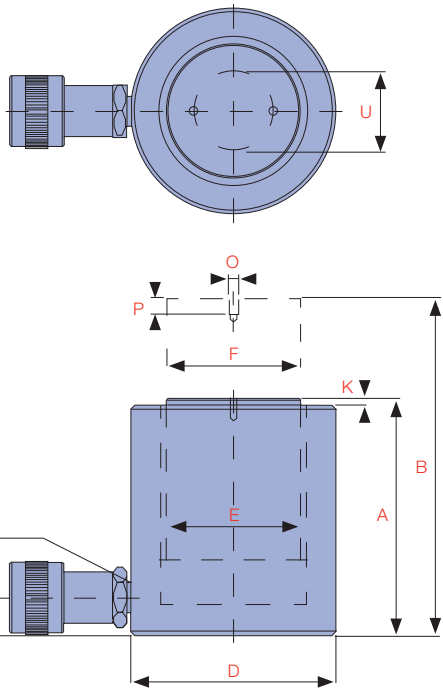

**i** **RJ-Series** cylinders offer short stroke high tonnage capacities from 150 - 200 ton

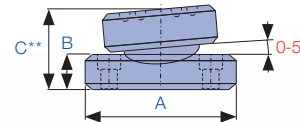

H Base to Advance Port (in)	K Load cap Protrusion from Cylinder Body (in)	O Tilt Saddle Mounting Thread (mm)	P Tilt Saddle Mounting Thread Length (in)	U Bolt Circle Diameter (in)	Weight (lbs)	Optional Tilt Saddle			Model Number	Handle Type	
						Model Number	A (in)	B (in)			C** (in)
0.69	0.20	M4 x 0.7	0.32	1.03	6.0	TSL-10	1.38	0.43	0.83	RLP-101	
0.69	0.12	M5 x 0.8	0.32	1.53	11.0	TSL-20	1.97	0.59	1.14	RLP-201	
0.75	0.12	M5 x 0.8	0.32	1.53	15.0	TSL-20	1.97	0.59	1.14	RLP-302	
0.94	0.08	M5 x 0.8	0.32	1.53	24.0	TSL-20	1.97	0.59	1.14	RLP-502	♣
1.25	0.04	M8 x 1.25	0.40	2.17	50.0	TSL-100	2.80	0.67	1.38	RLP-1002	♣

**HANDLE TYPE:** ♣ WELDED

\*\* C dimension equals tilt saddle protrusion from piston rod