

THE **RPLC-SERIES** IS A SINGLE ACTING LOAD RETURN PANCAKE LOCKING COLLAR CYLINDER. IT IS A COMPACT DESIGN THAT FEATURES A THREADED PISTON ROD AND LOCK RING.

When the lock ring is screwed down and engaged with the cylinder body, the load can be held mechanically for extended periods. Hoses and pumps can be removed until lowering is required. These cylinders are ideally suited to bridge construction and maintenance. All RPLC-Series cylinders feature a hard chrome bore for maximum corrosion resistance and a special coating on the piston rod and lock ring to resist corrosion and abrasion. Integral tilt saddle and an oil overflow port which restricts piston stroke is standard on all models.



RPLC-1002

Model Number	Cylinder Capacity ton* / max.		Stroke (in)	Cylinder Effective Area (in ²)	Oil Capacity (in ³)	A Collapsed Height (in)	B Extended Height (in)	D Outside Diameter (in)
RPLC-602	60	68.1	1.97	13.42	26.41	4.92	6.89	5.51
RPLC-1002	100	115.5	1.97	22.75	44.71	5.39	7.36	6.89
RPLC-1602	160	181.9	1.77	35.85	63.44	5.83	7.60	8.66
RPLC-2002	200	224.7	1.77	44.27	78.39	6.10	7.87	9.65
RPLC-2502	250	288.5	1.77	56.85	100.65	6.24	8.01	10.83
RPLC-4002	400	440.1	1.77	86.72	153.48	7.01	8.78	13.78
RPLC-5002	500	574.7	1.77	113.25	200.45	7.56	9.33	15.75

* Nominal Cylinder Capacity in ton - see max. values for actual capacity

SINGLE ACTING PANCAKE LOCKING COLLAR CYLINDERS

HARDENED GROOVED TILT SADDLE

on all models to prevent piston rod damage

LOW FRICTION COATING

on piston rod and lock nut enhances corrosion resistance

HARD CHROME PLATED BORE

for maximum corrosion resistance and cylinder life

OVERFLOW PORT

on the piston rod ensures cylinder is not over extended

LOCK RING

holds load mechanically

POWDER COATED FINISH

enhances appearance and reduces corrosion

PARKER

industry standard high flow coupling for compatibility



CAPACITY RANGE

60 - 500 ton

STROKE RANGE

1.77 - 1.97 in

MAXIMUM OPERATING PRESSURE

10,150 psi

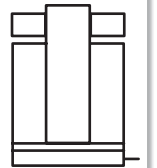

C

HYDRAULIC CYLINDERS

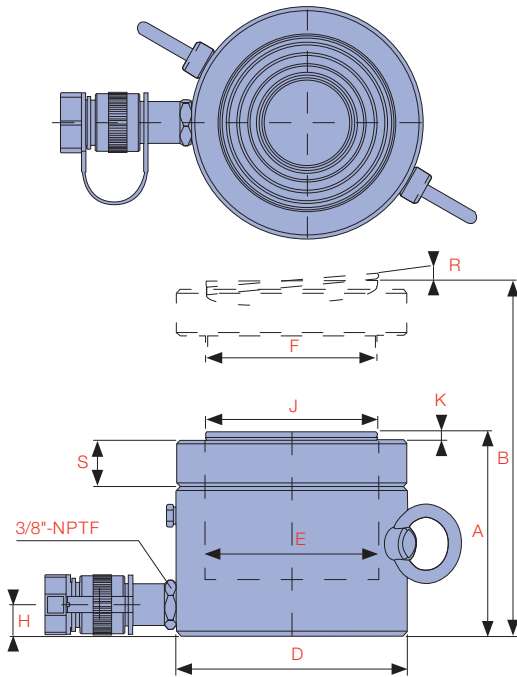

Optional DURAJET for fast retraction of load return cylinders. Consult Durapac



CAUTION...

RPLC-Series pancake locking collar cylinders must be used with the base fully engaged and on a firm stable jacking surface

E Cylinder Bore Diameter (in)	F Piston Rod Diameter (mm)**	H Base to Advance Port (in)	J Standard Load Cap Diameter (in)	K Load Cap Protrusion from Piston Rod (in)	R Tilt Saddle Maximum Angle	S Lock Ring Height (in)	Weight (lbs)	Model Number	Handle Type
4.13	TR104 x 4	0.75	3.78	0.24	5°	1.10	33.0	RPLC-602	◆
5.38	TR136 x 6	0.83	4.96	0.31	5°	1.22	57.3	RPLC-1002	◆
6.76	TR171 x 6	1.06	6.30	0.35	5°	1.57	97.0	RPLC-1602	◆
7.51	TR190 x 6	1.18	7.09	0.39	5°	1.69	125.7	RPLC-2002	◆
8.51	TR216 x 6	1.26	7.87	0.43	5°	1.73	163.2	RPLC-2502	◆
10.51	TR266 x 6	1.54	9.84	0.43	4°	2.17	295.5	RPLC-4002	◆
12.01	TR305 x 6	1.89	11.42	0.39	3°	2.44	416.7	RPLC-5002	◆

HANDLE TYPE: ◆ EYEBOLT

** TR is a metric trapezoidal thread